

This drawing should not be scaled. Dimensions to be verified on site. Any discrepancies should be referred to the Engineer prior to work being put in hand.

This drawing is the property of Waterman Transport & Development Limited, and the drawing is issued on the condition that it is not copied, reproduced, retained or disclosed to any unauthorised person, either wholly or in part without the consent in writing of Waterman Transport & Development Limited  
 Pickfords Wharf, Clink Street, London SE1 9DG t 020 7928 7888 f 020 7902 0992



**GENERAL NOTES**



Rev	Date	Description	By
A03	08.05.12	LAYOUT REVISED TO REFLECT DRG. EC4_Electrical Layout_Alyth A3-6; RE-ISSUED	SMcB
A02	27.03.12	PROJECT NAME UPDATED; ISSUED TO BOX.NET	LS
A01	15.02.12	ISSUED FOR PLANNING	PS

**Amendments**

Project: **Alyth Substation**

Title: **Proposed Substation Location & Planning Application Boundary**  
 PERTH AND KINROSS COUNCIL  
 DRAWING REF: 1200948/1

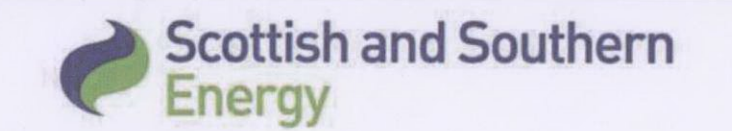

2 / 4 Canning Street Lane Edinburgh EH3 8ER  
 t 0131 221 7020 f 0131 221 7099  
 mail@waterman-group.co.uk www.watermangroup.com

**PLANNING**

Designed by	MK	Checked by	MK	Project No	C11791
Drawn by	AP	Date	02.02.12	Computer File No	C-11791-SS-04-0010 temporary.dwg
Scales @ A3		work to figured dimensions only 1:2500;1:50000			

Publisher	Zone	Category	Number	Revision
C	SS	04	0010	A03

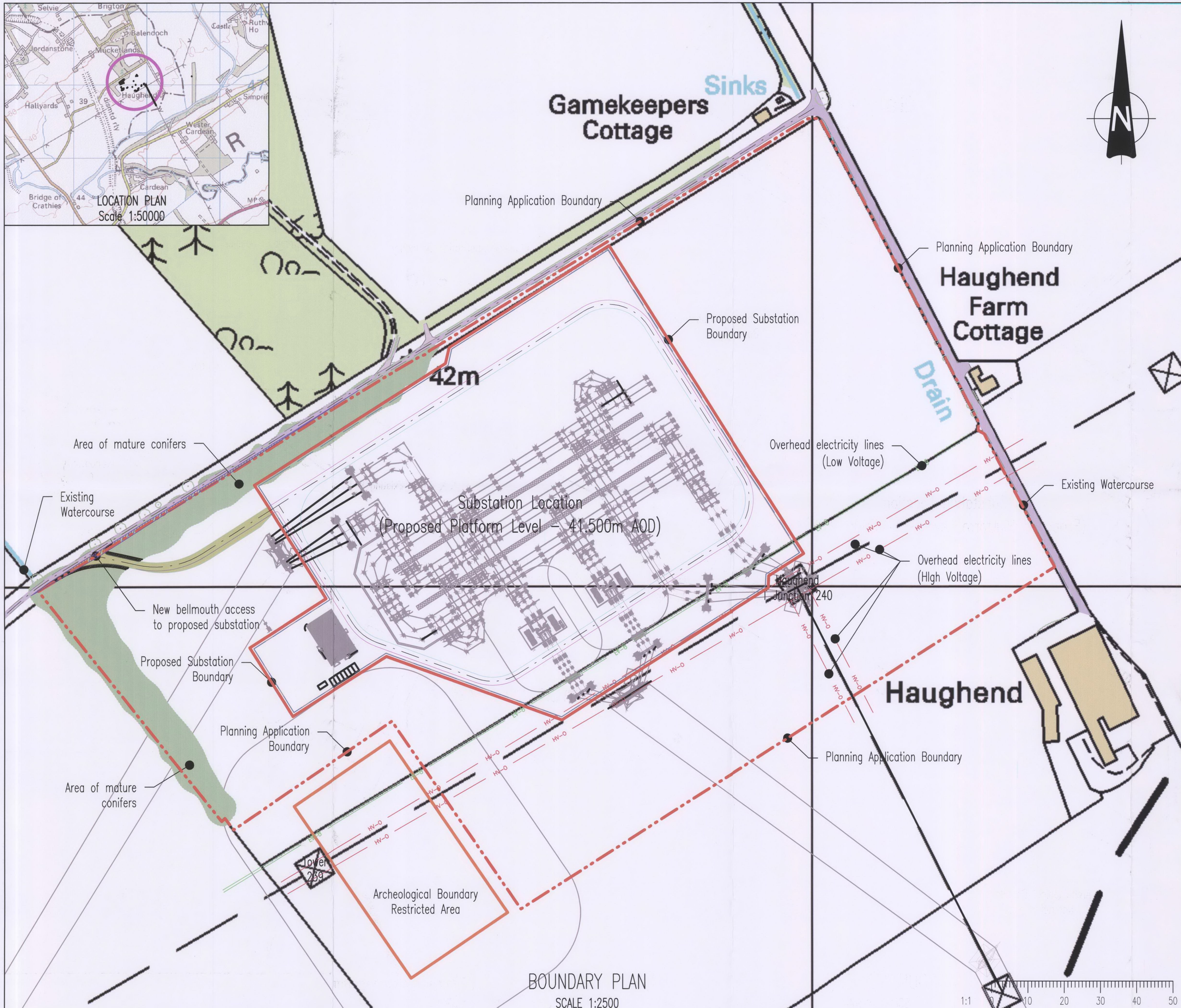

**BOUNDARY PLAN**  
SCALE 1:2500