

- NOTES
1. EXISTING WATER SUPPLY TO BE RE-DIRECTED BY OTHERS PRIOR TO DEMOLITION OF THE RAILWAY BRIDGE.
 2. ALL ARISING FROM THESE WORKS TO BE CONSIDERED CONTAMINATED FROM HISTORIC ROLLING STOCK UNLESS TEST RESULTS DEMONSTRATE OTHERWISE.
 3. EXISTING CARPARKWAY TO BE PROTECTED BY DEMOLITION CONTRACTOR DURING DEMOLITION WORKS. ANY DAMAGE TO BE MADE GOOD BY DEMOLITION CONTRACTOR.
 4. EXISTING BRISTONE WALLS TO BE REMOVED BY DEMOLITION CONTRACTOR AND STOCKFIELD LOCALITY (LOCATION TO BE AGREED) FOR CONCRETE WALL CONSTRUCTION (BY OTHERS).
 5. DEMOLITION MATERIAL ARISING FROM THE BRIDGE DEMOLITION TO BE SAVED AND TRANSPORTED A MAXIMUM OF 5 MILES TO AN AGREED AREA.

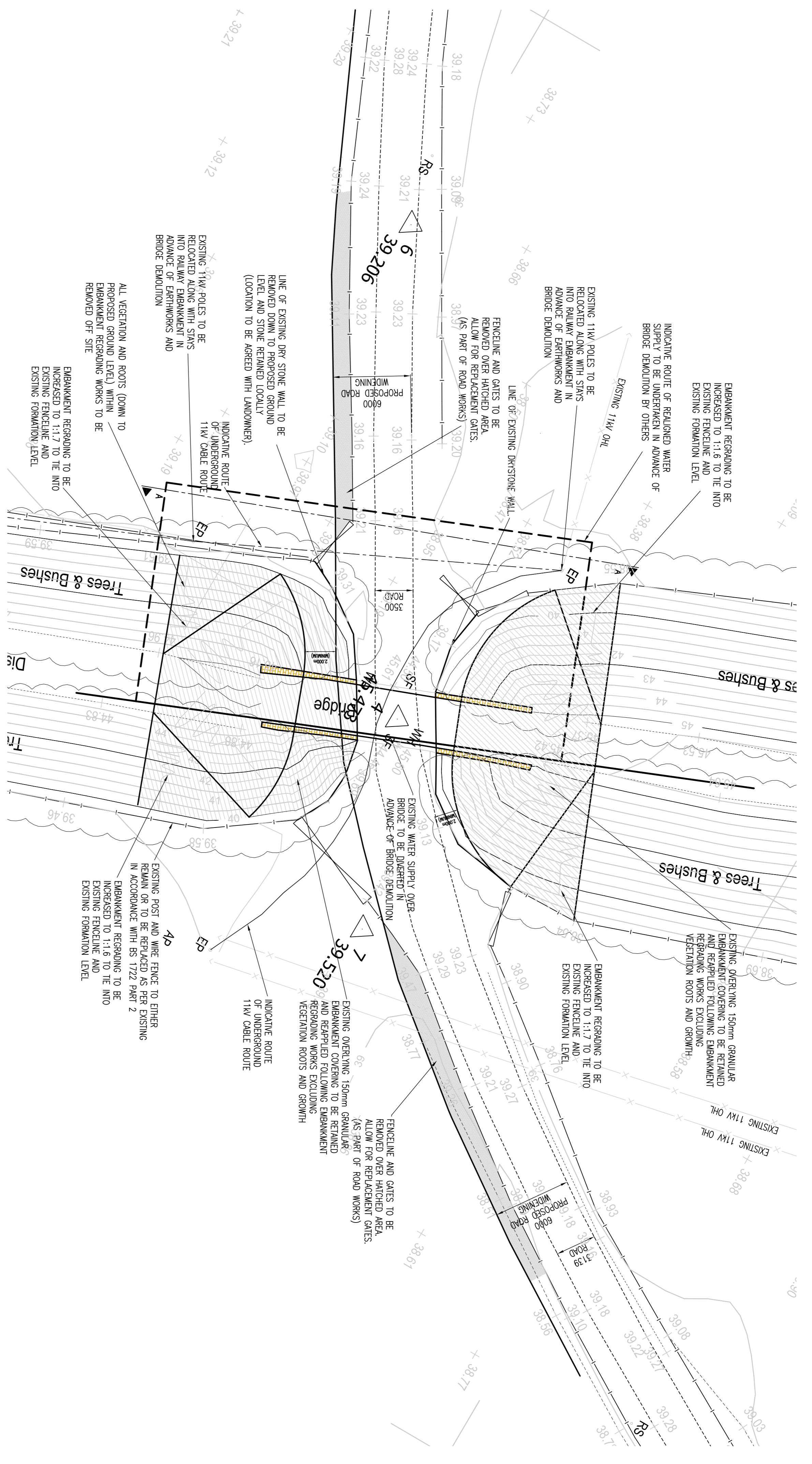

PLAN VIEW
SCALE 1:200

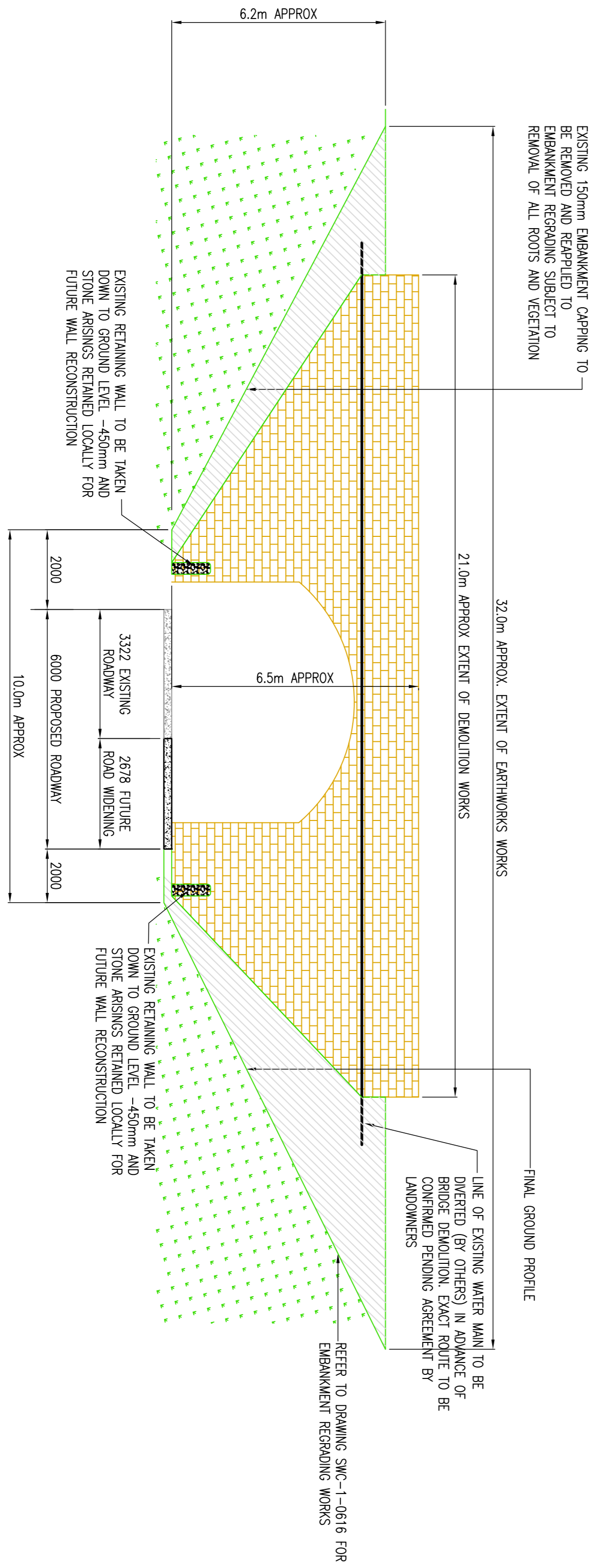

ELEVATION A-A
SCALE 1:100

INTERNAL DESIGN CHECK BOX

CIVIL	ELECTRICAL	PRIMARY	PROTECTION
-------	------------	---------	------------

SHE HAZARD BOX

IN ADDITION TO THE HAZARDS / RISKS NORMALLY ASSOCIATED WITH THE TYPES OF WORKS DETAILED ON THIS DRAWING, NOTE THE FOLLOWING SPECIFIC HAZARDS WHICH REQUIRE SPECIAL CONSIDERATIONS:

MAINTENANCE / CLEANING / OPERATION

EXCAVATION WORKS DEMOLITION WORKS AND ARISING FROM THE WORKS SHOULD BE CONSIDERED CONTAMINATED DUE TO THE HISTORIC PRESENCE OF RAILWAY ROLLING STOCK UNLESS CONTAMINATION TEST RESULTS DEMONSTRATE OTHERWISE. PLEASE REFER TO ASTUM/ENTERPRISE TECHNICAL QUERY ALYTH-10-0007 FOR FURTHER INFORMATION.

CONSTRUCTION

CONTRACTOR TO BE CONSCIOUS OF THE EXISTING BURIED 11kV CABLE AND OTHER SERVICES IDENTIFIED WITHIN THE ADEN GPS SURVEY AND OTHER SURVEY RECORDS. ALL EXCAVATION WORKS TO BE UNDERTAKEN IN ACCORDANCE WITH AMEY SAFE DIG POLICY AND PROCEDURES IN ADDITION TO HSS 47 AND HSS 6.

DECOMMISSIONING / DEMOLITION

DEMOLITION OF THE EXISTING OVERBRIDGE AND DRY STONE DYKES TO BE UNDERTAKEN BY A SPECIALIST DEMOLITION CONTRACTOR WITH PARTICULAR CONSIDERATION TO THE TEMPORARY WORKS REQUIRED FOR THE SUPPORT OF ARCH STRUCTURES. DEMOLITION METHODOLOGY TO BE SUBMITTED AND APPROVED BY THE ENGINEER IN ADVANCE OF THE WORKS.

FOR INFORMATION

DATE:	22-08-13	SCALE:	NTS	SIZE:	CAD A1
DRAWN BY:	DP	CHECKED BY:	SD	APPROVED BY:	JC



Unit 2F International House
Stanley Boulevard
Hamilton International Technology Park,
High Blarney, G72 0BN,
Telephone 01769 404690 Fax 01769 404691

Copyright © Enterprise Managed Services Ltd
All rights reserved. This drawing is supplied in any form by means of a graphical, electronic or mechanical system, or used for any purpose other than its designated purpose, without the written permission of Enterprise Managed Services Ltd.

DEMOLITION PLAN FOR
EXISTING DISSUSED RAILWAY LINE

CLIENT NAME: SHE T
PROJECT NAME: HAUGHEND ROAD UPGRADE

SITE NAME: ALYTH SUBSTATION
DRAWING NUMBER: SWC-1-0608
SHEET NUMBER: 1 OF 1
REVISION: 03