

PLAN  
SCALE 1:250

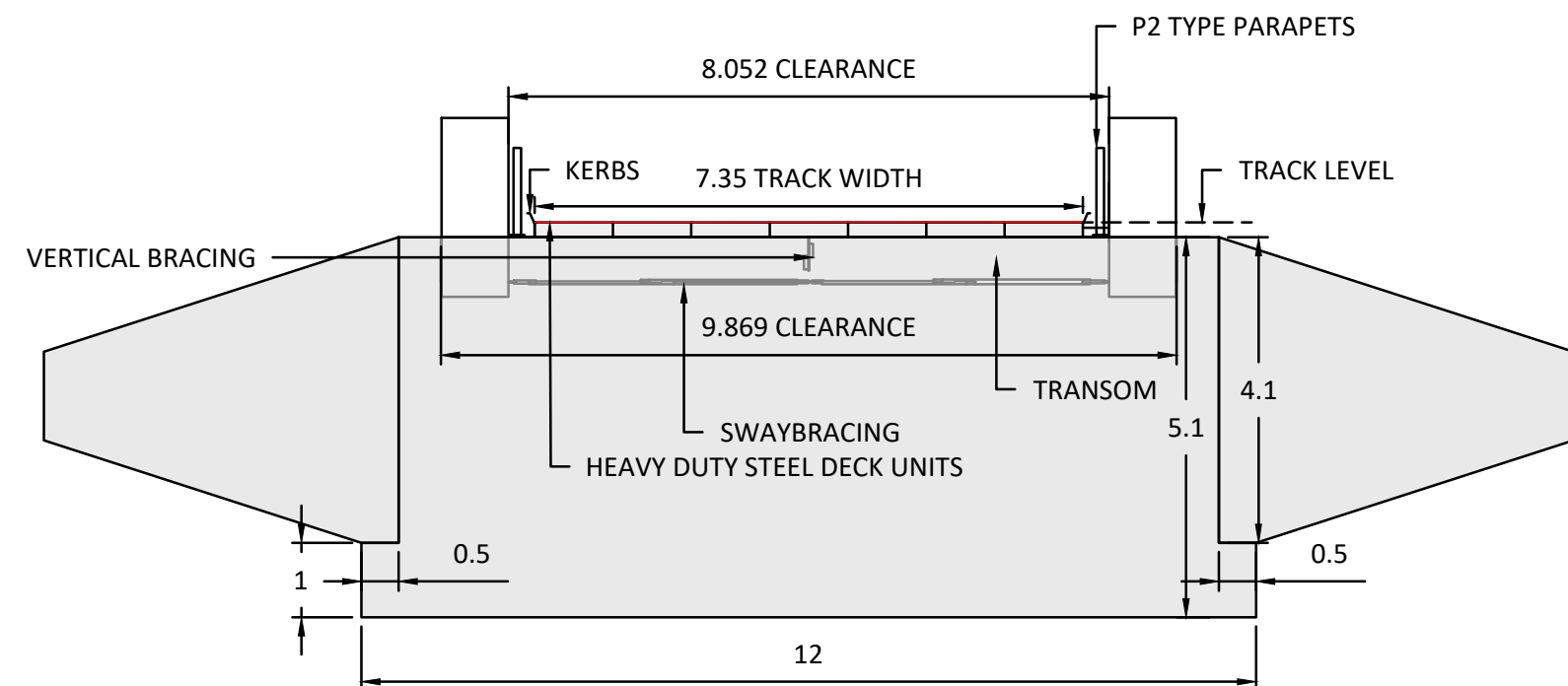

SECTION A-A  
SCALE 1:100

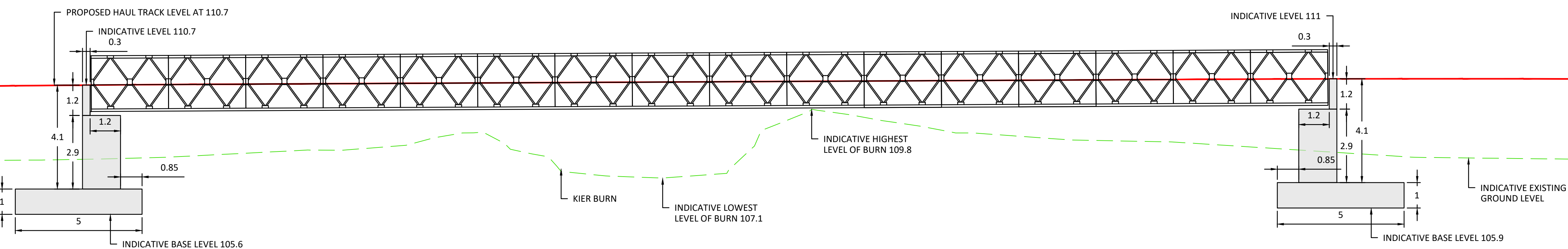

TYPICAL ELEVATION  
SCALE 1:100



ELEVATION B-B  
SCALE 1:100

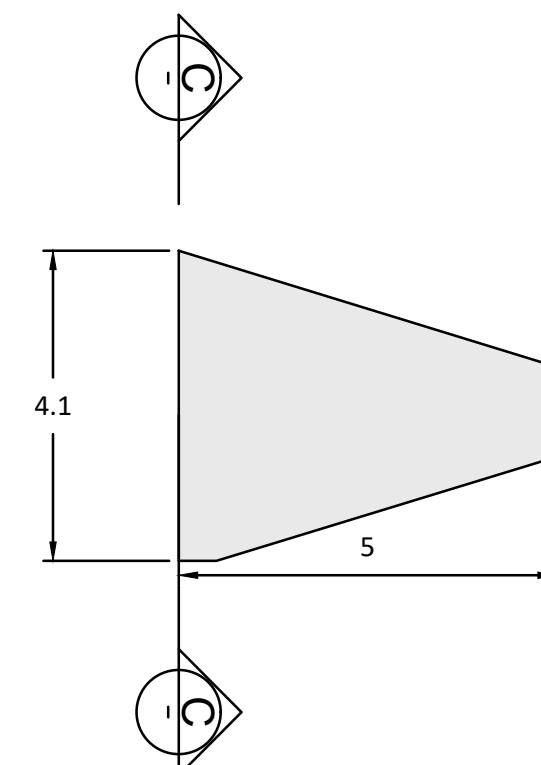

SECTION C-C  
SCALE 1:100

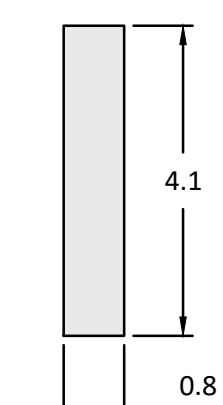

WING ELEVATION  
SCALE 1:100

- NOTES:
1. ONLY SCALE FOR PLANNING PURPOSES.
  2. ALL DIMENSIONS ARE SHOWN IN METRES UNLESS OTHERWISE STATED.
  3. THE DRAWING IS TO BE PRINTED IN COLOUR.
  4. THE EARTHWORKS ARE AT 1 in 3 SLOPE. THIS IS SUBJECT TO CHANGE BASED ON GROUND INVESTIGATION RESULTS.
  5. ALL DRAWINGS ARE TO BE READ IN CONJUNCTION WITH RELEVANT SPECIFICATION AND ALL OTHER RELEVANT DRAWINGS.
  6. THIS DRAWING SHALL NOT BE USED FOR CONSTRUCTION PURPOSE.
  7. BRIDGE ABUTMENTS SHOWN ARE PRELIMINARY DESIGN ONLY AND ARE INDICATIVE IN SHAPE AND SIZE. ACTUAL SHAPE, SIZE, LEVELS AND FINAL POSITIONS OF THE ABUTMENTS WILL BE DETERMINED AT DETAILED DESIGN ONCE ANALYSIS OF THE GROUND INVESTIGATION AND BRIDGE STRUCTURE HAVE BEEN COMPLETED.

KEY:

HAUL TRACK CENTRELINE

PROPOSED DESIGN

KEIR BURN BRIDGE

Designer's Site Specific Risk Assessment

This assessment is for non-standard or unusual Hazards and it is expected that Hazards associated with standard installations and designs are well understood by a competent Contractor.

By: \_\_\_\_\_ Date: \_\_\_\_\_

☐ No works associated with this drawing

HAZARDS/ ACTIVITY - Assessed as Low (L) / Medium (M) / High (H)

<input type="checkbox"/> Falls From Height	<input type="checkbox"/> Drowning/Fall onto Rebar
<input type="checkbox"/> Hazardous Material	<input type="checkbox"/> Contaminated Land
<input type="checkbox"/> Excavation/Service Strike	<input type="checkbox"/> Poor Ground conditions
<input type="checkbox"/> HAVS	<input type="checkbox"/> Site Fabrication/Drilling
<input type="checkbox"/> Confined Workplace	<input type="checkbox"/> Manual Handling
<input type="checkbox"/> Access/Egress	<input type="checkbox"/> Stored Energy
<input type="checkbox"/> Weight Limit	<input type="checkbox"/> Congested site
<input type="checkbox"/> Residual Electricity	<input type="checkbox"/> Existing equipment in close proximity

Interfaces: ☐ Public ☐ Operatives ☐ Vehicle/Plant

WHO COULD BE HARMED?

<input type="checkbox"/> Construction operatives	<input type="checkbox"/> Existing work instruction
<input type="checkbox"/> Dismantling crew	<input type="checkbox"/> Method detailed on drawing
<input type="checkbox"/> Future maintenance crew	<input type="checkbox"/> Method detailed on separate document

CONTROL MEASURES

TEMPORARY WORKS

<input type="checkbox"/> No temporary works required	} Complete temporary works design check certificate ENG-SF-0101C						
<input type="checkbox"/> Temporary works required and documented separately							
<input type="checkbox"/> Drawing contains temporary works:							
<table><tr><td>DC0</td><td rowspan="4">}</td></tr><tr><td>DC1</td></tr><tr><td>DC2</td></tr><tr><td>DC3</td></tr><tr><td>DC4</td><td>Abnormal Highly innovative</td></tr></table>		DC0	}	DC1	DC2	DC3	DC4
DC0	}						
DC1							
DC2							
DC3							
DC4	Abnormal Highly innovative						

Level 1 Control

☐ OK to proceed, no significant design hazards and risks, standard control measures apply.

Level 2 Control

☐ OK to proceed as detailed in existing work instruction or procedure detailed on drawing or separate document.

Level 3 Control

☐ OK to proceed providing specific design hazards and risks have been recognised, acknowledged and understood by the operation team. Site operatives may require additional instruction/training

CDM REGULATIONS RESIDUAL RISKS

Design based hazards are actively eliminated where possible. Where hazards cannot be eliminated, this symbol along with an attached note will identify the hazard and indicate that an action is required by the person supervising the works to manage the design hazard during construction.

Other than those noted, we are not aware of any further residual design risks apart from those that a competent contractor would ordinarily consider.

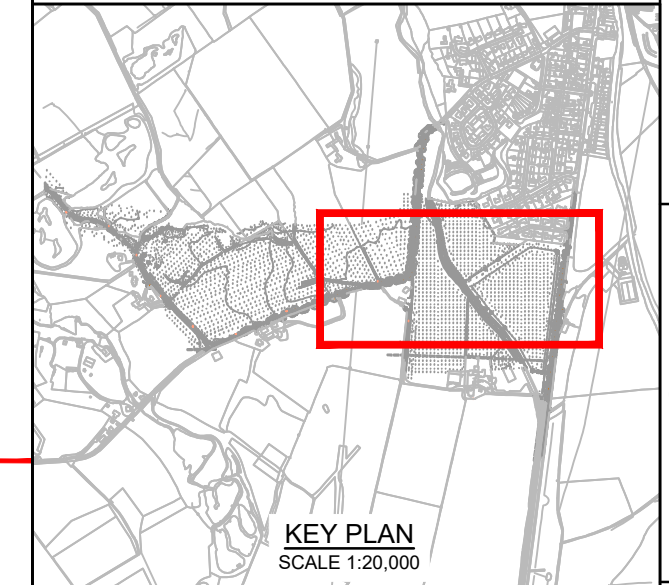
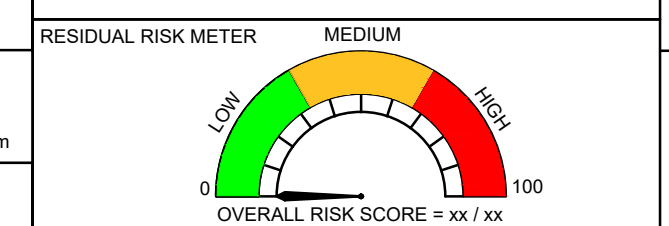

DRAWN	RS	REMARKS:			
CHKD	SRA	THIRD ISSUE - SCALE BAR ADDED			
DESIGN	RS	STATUS	S5	DATE	03/06/2025
APPD	FY	FOR ACCEPTANCE		REV	P03
DRAWN	RS	REMARKS:			
CHKD	SRA	SECOND ISSUE - MINOR AMENDMENTS			
DESIGN	RS	STATUS	S5	DATE	14/05/2025
APPD	FY	FOR ACCEPTANCE		REV	P02
DRAWN	RS	REMARKS:			
CHKD	SRA	FIRST ISSUE			
DESIGN	RS	STATUS	S5	DATE	24/01/2025
APPD	FY	FOR ACCEPTANCE		REV	P01

Scottish & Southern Electricity Networks

Balfour Beatty

PROJECT NAME:  
ASTI-ECE

LOCATION:  
CAMBUSHINNIE 400KV S/S

SITE:  
CMBS

TITLE:  
BRACO HAUL TRACK  
KEIR BURN BRIDGE  
TYPICAL SECTION

SIZE	SCALE	FORMAT	SHEET No.
A1	As Shown	ACAD	01 OF 01

DRAWING No.  
CMBS-LT520-BB-TRAC-ZZ-D-H-0029